

Swivel female to BSP parallel male

BOOK INDEX

SECTION INDEX

24° female and Viton O-ring
with a profile to W DIN 3861
BSP parallel male thread with
Viton elastomeric soft seal

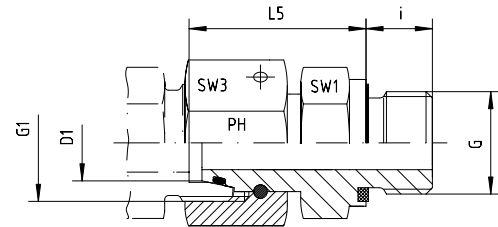

Series	Pressure PN	Tube O.D. D1	Thread		Approx. Dimensions				Part code
			G	G1	L5	i	SW1	SW3	
L	500	6	G 1/8"	M 12 x 1.5	24.5	8	14	14	EGE-DKOL-06-G 1/8"-wd
L	500	6	G 1/4"	M 12 x 1.5	27.0	12	19	14	EGE-DKOL-06-G 1/4"-wd
L	400	6	G 3/8"	M 12 x 1.5	28.0	12	22	14	EGE-DKOL-06-G 3/8"-wd
L	500	8	G 1/8"	M 14 x 1.5	25.5	8	14	17	EGE-DKOL-08-G 1/8"-wd
L	500	8	G 1/4"	M 14 x 1.5	29.5	12	19	17	EGE-DKOL-08-G 1/4"-wd
L	400	8	G 3/8"	M 14 x 1.5	29.5	12	22	17	EGE-DKOL-08-G 3/8"-wd
L	400	8	G 1/2"	M 14 x 1.5	29.0	14	27	17	EGE-DKOL-08-G 1/2"-wd
L	500	10	G 1/8"	M 16 x 1.5	25.5	8	14	19	EGE-DKOL-10-G 1/8"-wd
L	500	10	G 1/4"	M 16 x 1.5	27.5	12	19	19	EGE-DKOL-10-G 1/4"-wd
L	400	10	G 3/8"	M 16 x 1.5	30.0	12	22	19	EGE-DKOL-10-G 3/8"-wd
L	400	10	G 1/2"	M 16 x 1.5	30.0	14	27	19	EGE-DKOL-10-G 1/2"-wd
L	400	12	G 1/8"	M 18 x 1.5	26.0	8	17	22	EGE-DKOL-12-G 1/8"-wd
L	400	12	G 1/4"	M 18 x 1.5	28.0	12	19	22	EGE-DKOL-12-G 1/4"-wd
L	400	12	G 3/8"	M 18 x 1.5	34.0	12	22	22	EGE-DKOL-12-G 3/8"-wd
L	400	12	G 1/2"	M 18 x 1.5	34.5	14	27	22	EGE-DKOL-12-G 1/2"-wd
L	400	15	G 3/8"	M 22 x 1.5	35.0	12	24	27	EGE-DKOL-15-G 3/8"-wd
L	400	15	G 1/2"	M 22 x 1.5	35.0	14	27	27	EGE-DKOL-15-G 1/2"-wd
L	250	15	G 3/4"	M 22 x 1.5	48.0	16	32	27	EGE-DKOL-15-G 3/4"-wd
L	400	18	G 3/8"	M 26 x 1.5	34.0	12	24	32	EGE-DKOL-18-G 3/8"-wd
L	400	18	G 1/2"	M 26 x 1.5	31.5	14	27	32	EGE-DKOL-18-G 1/2"-wd
L	315	18	G 3/4"	M 26 x 1.5	33.0	16	32	32	EGE-DKOL-18-G 3/4"-wd
L	250	22	G 1/2"	M 30 x 2	32.0	14	27	36	EGE-DKOL-22-G 1/2"-wd
L	250	22	G 3/4"	M 30 x 2	32.5	16	32	36	EGE-DKOL-22-G 3/4"-wd
L	250	22	G 1"	M 30 x 2	33.0	18	41	36	EGE-DKOL-22-G 1"-wd
L	250	28	G 3/4"	M 36 x 2	35.0	16	32	41	EGE-DKOL-28-G 3/4"-wd
L	250	28	G 1"	M 36 x 2	35.0	18	41	41	EGE-DKOL-28-G 1"-wd
L	250	35	G 1 1/4"	M 45 x 2	42.5	20	50	50	EGE-DKOL-35-G 1 1/4"-wd
L	250	42	G 1 1/4"	M 52 x 2	40.5	20	50	60	EGE-DKOL-42-G 1 1/4"-wd
L	250	42	G 1 1/2"	M 52 x 2	46.5	22	55	60	EGE-DKOL-42-G 1 1/2"-wd

Series	Pressure PN	Tube O.D. D1	Thread		Approx. Dimensions				Part code
			G	G1	L5	i	SW1	SW3	
S	800	6	G 1/4"	M 14 x 1.5	27.0	12	19	17	EGE-DKOS-06-G 1/4"-wd
S	800	8	G 1/4"	M 16 x 1.5	29.5	12	19	19	EGE-DKOS-08-G 1/4"-wd
S	800	8	G 3/8"	M 16 x 1.5	29.5	12	22	19	EGE-DKOS-08-G 3/8"-wd
S	800	10	G 1/4"	M 18 x 1.5	27.5	12	19	22	EGE-DKOS-10-G 1/4"-wd
S	800	10	G 3/8"	M 18 x 1.5	32.0	12	22	22	EGE-DKOS-10-G 3/8"-wd
S	630	10	G 1/2"	M 18 x 1.5	32.0	14	27	22	EGE-DKOS-10-G 1/2"-wd
S	630	12	G 1/4"	M 20 x 1.5	42.0	12	19	24	EGE-DKOS-12-G 1/4"-wd
S	630	12	G 3/8"	M 20 x 1.5	34.0	12	22	24	EGE-DKOS-12-G 3/8"-wd
S	630	12	G 1/2"	M 20 x 1.5	34.5	14	27	24	EGE-DKOS-12-G 1/2"-wd
S	630	14	G 1/2"	M 22 x 1.5	36.5	14	27	27	EGE-DKOS-14-G 1/2"-wd
S	630	16	G 3/8"	M 24 x 1.5	37.0	12	24	30	EGE-DKOS-16-G 3/8"-wd
S	630	16	G 1/2"	M 24 x 1.5	37.0	14	27	30	EGE-DKOS-16-G 1/2"-wd
S	420	16	G 3/4"	M 24 x 1.5	39.0	16	32	30	EGE-DKOS-16-G 3/4"-wd
S	420	20	G 1/2"	M 30 x 2	38.0	14	27	36	EGE-DKOS-20-G 1/2"-wd
S	420	20	G 3/4"	M 30 x 2	43.0	16	32	36	EGE-DKOS-20-G 3/4"-wd
S	420	20	G 1"	M 30 x 2	55.0	18	41	36	EGE-DKOS-20-G 1"-wd
S	420	25	G 3/4"	M 36 x 2	58.0	16	32	46	EGE-DKOS-25-G 3/4"-wd
S	420	25	G 1"	M 36 x 2	48.0	18	41	46	EGE-DKOS-25-G 1"-wd
S	420	30	G 1"	M 42 x 2	46.0	18	41	50	EGE-DKOS-30-G 1"-wd
S	420	30	G 1 1/4"	M 42 x 2	51.0	20	50	50	EGE-DKOS-30-G 1 1/4"-wd
S	420	38	G 1 1/2"	M 52 x 2	60.0	22	55	60	EGE-DKOS-38-G 1 1/2"-wd