



24° compression fittings to ISO 8434-1 / DIN 2354

Male stud run tee to NPT

BOOK INDEX

SECTION INDEX

to ISO 8434-1 / DIN 2353

LL, L and S series

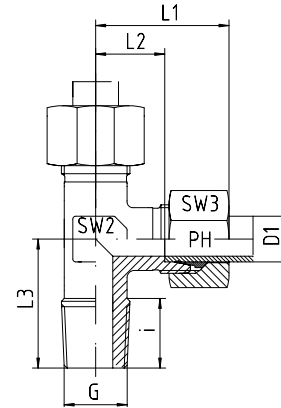

Series	Pressure PN	Tube O.D. D1	Thread G	Approx. Dimensions						Part code
				L1	L2	L3	i	SW2	SW3	
LL	100	4	1/8" NPT	21	11.0	17	10.0	9	10	LE-LL-04-1/8"-NPT
LL	100	6	1/8" NPT	21	9.5	17	10.0	9	14	LE-LL-06-1/8"-NPT
LL	100	8	1/8" NPT	23	11.5	20	10.0	12	17	LE-LL-08-1/8"-NPT

Series	Pressure PN	Tube O.D. D1	Thread G	Approx. Dimensions						Part code
				L1	L2	L3	i	SW2	SW3	
L	315	6	1/8" NPT	27	12.0	20	10.0	12	14	LE-L-06-1/8"-NPT
L	315	6	1/4" NPT	29	14.0	26	15.0	12	14	LE-L-06-1/4"-NPT
L	315	8	1/4" NPT	29	14.0	26	15.0	12	17	LE-L-08-1/4"-NPT
L	315	10	1/4" NPT	30	15.0	27	15.0	14	19	LE-L-10-1/4"-NPT
L	315	10	3/8" NPT				15.3	17	19	LE-L-10-3/8"-NPT
L	315	10	1/2" NPT				20.0	17	19	LE-L-10-1/2"-NPT
L	315	12	1/4" NPT	32	17.0	28	15.0	17	22	LE-L-12-1/4"-NPT
L	315	12	3/8" NPT	32	17.0	28	15.3	17	22	LE-L-12-3/8"-NPT
L	315	12	1/2" NPT				20.0	17	22	LE-L-12-1/2"-NPT
L	315	15	3/8" NPT				15.3	19	27	LE-L-15-3/8"-NPT
L	315	15	1/2" NPT	36	21.0	34	20.0	19	27	LE-L-15-1/2"-NPT
L	315	18	1/2" NPT	40	23.5	36	20.0	24	32	LE-L-18-1/2"-NPT
L	160	22	3/4" NPT	44	27.5	42	20.0	27	36	LE-L-22-3/4"-NPT
L	160	28	1" NPT	47	30.5	48	25.0	36	41	LE-L-28-1"-NPT
L	160	35	1 1/4" NPT	56	34.5	54	25.5	41	50	LE-L-35-1 1/4"-NPT
L	160	42	1 1/2" NPT	63	40.0	61	26.0	50	60	LE-L-42-1 1/2"-NPT

Series	Pressure PN	Tube O.D. D1	Thread G	Approx. Dimensions						Part code
				L1	L2	L3	i	SW2	SW3	
S	630	6	1/4" NPT	31	16.0	26	15.0	12	17	LE-S-06-1/4"-NPT
S	630	8	1/4" NPT	32	17.0	27	15.0	14	19	LE-S-08-1/4"-NPT
S	630	10	1/4" NPT				15.0	17	22	LE-S-10-1/4"-NPT
S	630	10	3/8" NPT	34	17.5	28	15.3	17	22	LE-S-10-3/8"-NPT
S	630	10	1/2" NPT				20.0	17	22	LE-S-10-1/2"-NPT
S	630	12	1/4" NPT				15.0	17	24	LE-S-12-1/4"-NPT
S	630	12	3/8" NPT	38	21.5	28	15.3	17	24	LE-S-12-3/8"-NPT
S	630	12	1/2" NPT	38	21.5	33	20.0	19	24	LE-S-12-1/2"-NPT
S	630	14	1/2" NPT	40	22.0	34	20.0	19	27	LE-S-14-1/2"-NPT
S	400	16	1/2" NPT	43	24.5	36	20.0	24	30	LE-S-16-1/2"-NPT
S	400	20	3/4" NPT	48	26.5	42	20.0	27	36	LE-S-20-3/4"-NPT
S	400	25	1" NPT	54	30.0	48	25.0	36	46	LE-S-25-1"-NPT
S	400	30	1 1/4" NPT	62	35.5	54	25.5	41	50	LE-S-30-1 1/4"-NPT
S	315	38	1 1/2" NPT	72	41.0	61	26.0	50	60	LE-S-38-1 1/2"-NPT

8