

Male stud run tee to BSP parallel

BOOK INDEX

SECTION INDEX

to ISO 8434-1 / DIN 2353

L and S series

Form B sealing shoulder

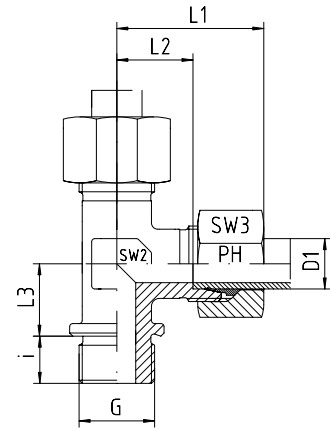
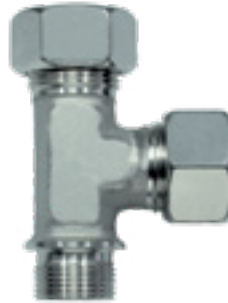

Series	Pressure PN	Tube O.D. D1	Thread G	Approx. Dimensions						Part code
				L1	L2	L3	i	SW2	SW3	
L	160	22	G 3/4" zyl	44	27.5	26	16	27	36	LE-L-22-R 3/4"-z
L	160	28	G 1" zyl	47	30.5	30	18	36	41	LE-L-28-R 1"-z
L	160	35	G 1 1/4" zyl	56	34.5	34	20	41	50	LE-L-35-R 1 1/4"-z
L	160	42	G 1 1/2" zyl	63	40.0	39	22	50	60	LE-L-42-R 1 1/2"-z

Series	Pressure PN	Tube O.D. D1	Thread G	Approx. Dimensions						Part code
				L1	L2	L3	i	SW2	SW3	
S	400	20	G 3/4" zyl	48	26.5	26	16	27	36	LE-S-20-R 3/4"-z
S	250	25	G 1" zyl	54	30.0	30	18	36	46	LE-S-25-R 1"-z
S	160	30	G 1 1/4" zyl	62	35.5	34	20	41	50	LE-S-30-R 1 1/4"-z
S	160	38	G 1 1/2" zyl	72	41.0	39	22	50	60	LE-S-38-R 1 1/2"-z

Fittings can be supplied with nuts with silver-plated threads to help to prevent galling, or can be supplied body only - no nut or cutting ring.

If you require silver-plated nuts, use suffix -SC. If you require body only, use suffix -OMD.

Eg. LE-L-22-R 3/4"-z-SC, or LE-L-22-R 3/4"-z-OMD