

to ISO 8434-1 / DIN 2353

LL, L and S series

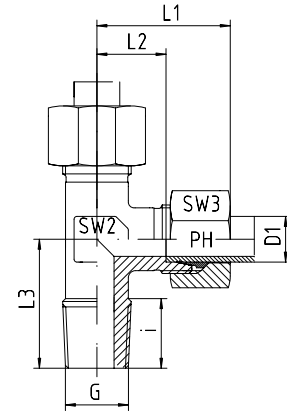

Series	Pressure PN	Tube O.D. D1	Thread G	Approx. Dimensions						Part code
				L1	L2	L3	i	SW2	SW3	
LL	100	4	R 1/8" keg	21	11.0	17	8	9	10	LE-LL-04-R 1/8"-k
LL	100	6	R 1/8" keg	21	9.5	17	8	9	12	LE-LL-06-R 1/8"-k
LL	100	8	R 1/8" keg	23	11.5	20	8	12	14	LE-LL-08-R 1/8"-k

Series	Pressure PN	Tube O.D. D1	Thread G	Approx. Dimensions						Part code
				L1	L2	L3	i	SW2	SW3	
L	315	6	R 1/8" keg	27	12.0	20	8	12	14	LE-L-06-R 1/8"-k
L	315	6	R 1/4" keg	27	12.0	26	12	12	14	LE-L-06-R 1/4"-k
L	315	8	R 1/4" keg	29	14.0	26	12	12	17	LE-L-08-R 1/4"-k
L	315	8	R 3/8" keg	32	17.0	28	12	14	17	LE-L-08-R 3/8"-k
L	315	10	R 1/8" keg				8	14	19	LE-L-10-R 1/8"-k
L	315	10	R 1/4" keg	30	15.0	27	12	14	19	LE-L-10-R 1/4"-k
L	315	10	R 3/8" keg	30	15.0	28	12	17	19	LE-L-10-R 3/8"-k
L	315	10	R 1/2" keg				14	17	19	LE-L-10-R 1/2"-k
L	315	12	R 1/4" keg	32	17.5	27	12	17	22	LE-L-12-R 1/4"-k
L	315	12	R 3/8" keg	32	17.5	28	12	17	22	LE-L-12-R 3/8"-k
L	315	12	R 1/2" keg				14	17	22	LE-L-12-R 1/2"-k
L	315	15	R 3/8" keg				12	19	27	LE-L-15-R 3/8"-k
L	315	15	R 1/2" keg	36	21.0	34	14	19	27	LE-L-15-R 1/2"-k
L	315	18	R 1/2" keg	40	23.5	36	14	24	32	LE-L-18-R 1/2"-k

Series	Pressure PN <sup>(1)</sup>	Tube O.D. D1	Thread G	Approx. Dimensions						Part code
				L1	L2	L3	i	SW2	SW3	
S	630	6	R 1/4" keg	31	16.5	26	12	12	17	LE-S-06-R 1/4"-k
S	630	8	R 1/4" keg	32	17.0	27	12	14	19	LE-S-08-R 1/4"-k
S	630	10	R 3/8" keg	34	17.5	28	12	17	22	LE-S-10-R 3/8"-k
S	630	12	R 3/8" keg	38	21.5	28	12	17	24	LE-S-12-R 3/8"-k
S	630	12	R 1/2" keg	38	21.5	33	14	19	24	LE-S-12-R 1/2"-k
S	630	14	R 1/2" keg	40	22.0	32	14	19	27	LE-S-14-R 1/2"-k
S	400	16	R 1/2" keg	43	24.5	32	14	24	30	LE-S-16-R 1/2"-k

<sup>(1)</sup> These pressure ratings are only valid when screwed into a taper female thread.

Fittings can be supplied with nuts with silver-plated threads to help to prevent galling, or can be supplied body only - no nut or cutting ring.

If you require silver-plated nuts, use suffix -SC. If you require body only, use suffix -OMD.

Eg. LE-L-12-M 16x1.5-k-SC, or LE-L-12-M 16x1.5-k-OMD.