

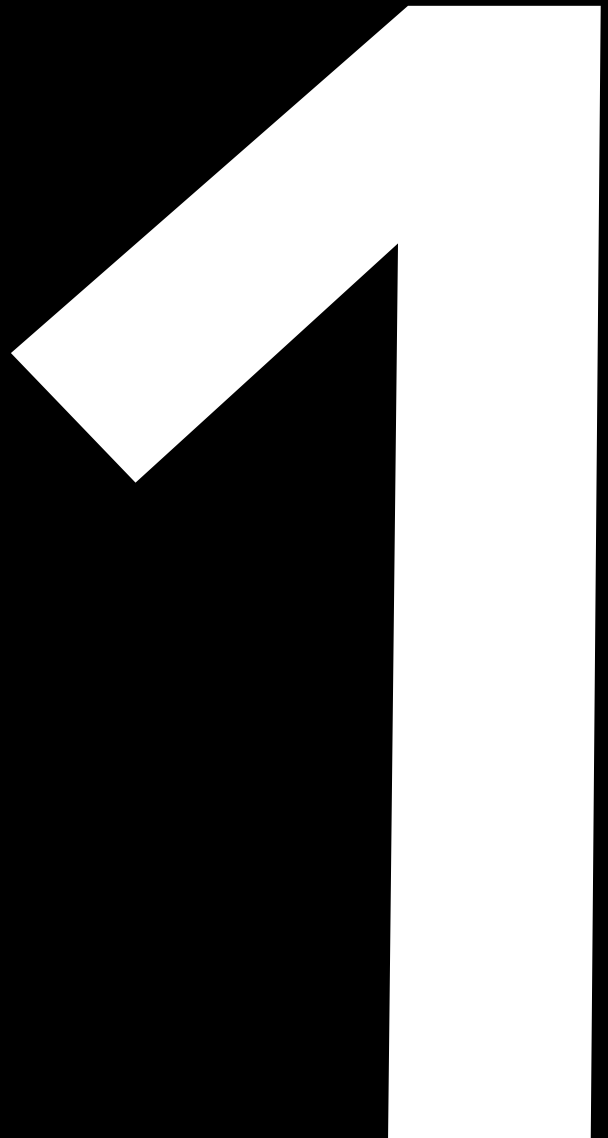

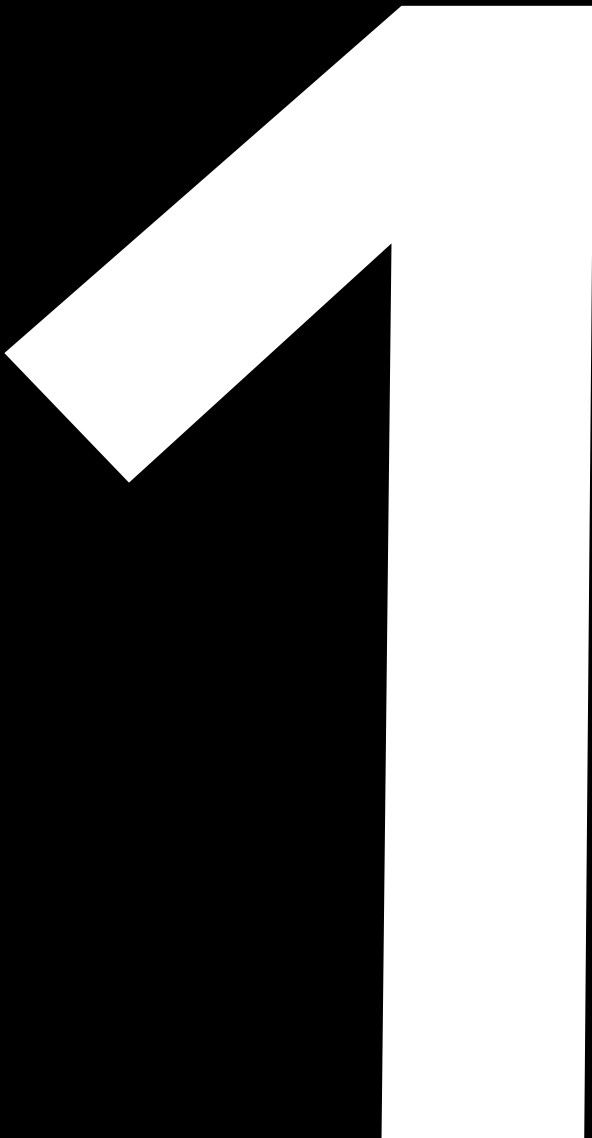

Pegasus
hydraulics

Rotary fittings







	Product Groups	Page
	Application	11.02
	Rotary fittings	11.03



These rotary fittings are designed to connect tube to equipment by way of allowing rotation within the sealed connection. They are designed for low rotation speeds, have a low initiation torque, are leak free and require zero maintenance.

Note: To ensure that these fittings can operate free of any torque introduced by misaligned tube, we recommend a flexible connection to the compression end. The life of the sealing elements of these fittings is dependent upon the operating pressure, rotation speed (RPM) and medium.

These fittings are only designed for use with lubricating media (such as hydraulic fluids) and are good for operating temperatures between -15°C to $+100^{\circ}\text{C}$.

Other connections and sealing combinations are available upon request.

Elbow

BOOK INDEX

SECTION INDEX

ISO 8434-1 / DIN 2353 connection
to BSP parallel male with Viton
captive seal

Fitting body machined from stainless bar

Internal seal - PTFE

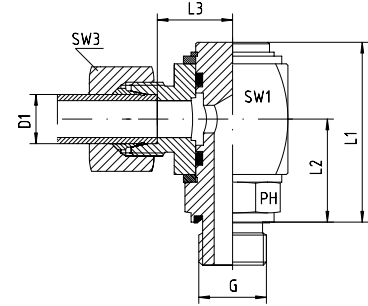

Series	Pressure PB	Tube O.D.		Approx. Dimensions					Part code
		D1	G	L1	L2	L3	SW1	SW3	
L	250	6	1/8"	47.0	26.5	16.5	27	14	DGWE-L-06-G 1/8"-wd
L	250	6	1/4"	47.5	26.5	16.5	27	14	DGWE-L-06-G 1/4"-wd
L	250	6	3/8"	47.5	26.5	16.5	27	14	DGWE-L-06-G 3/8"-wd
L	250	8	1/4"	47.5	26.5	16.5	27	17	DGWE-L-08-G 1/4"-wd
L	250	8	3/8"	47.5	26.5	16.5	27	17	DGWE-L-08-G 3/8"-wd
L	250	10	1/4"	47.5	26.5	17.5	27	19	DGWE-L-10-G 1/4"-wd
L	250	10	3/8"	47.5	26.5	17.5	27	19	DGWE-L-10-G 3/8"-wd
L	250	12	1/4"	47.5	26.5	17.5	27	22	DGWE-L-12-G 1/4"-wd
L	250	12	3/8"	47.5	26.5	17.5	27	22	DGWE-L-12-G 3/8"-wd
L	250	12	1/2"	58.5	33.5	23.0	36	22	DGWE-L-12-G 1/2"-wd
L	250	15	1/2"	58.5	33.5	24.0	36	27	DGWE-L-15-G 1/2"-wd
L	160	18	1/2"	58.5	33.5	23.5	36	32	DGWE-L-18-G 1/2"-wd
L	160	22	3/4"	66.0	38.0	27.5	41	36	DGWE-L-22-G 3/4"-wd
L	100	28	1"	72.0	42.5	29.5	46	41	DGWE-L-28-G 1"-wd
L	100	35	1 1/4"					50	DGWE-L-35-G 1 1/4"-wd
L	100	42	1 1/2"					60	DGWE-L-42-G 1 1/2"-wd

Series	Pressure PB	Tube O.D.		Approx. Dimensions					Part code
		D1	G	L1	L2	L3	SW1	SW3	
S	400	6	1/4"	47.5	26.5	18.5	27	17	DGWE-S-06-G 1/4"-wd
S	400	6	3/8"	47.5	26.5	18.5	27	17	DGWE-S-06-G 3/8"-wd
S	400	8	1/4"	47.5	26.5	18.5	27	19	DGWE-S-08-G 1/4"-wd
S	400	8	3/8"	47.5	26.5	18.5	27	19	DGWE-S-08-G 3/8"-wd
S	400	10	1/4"	47.5	26.5	18.0	27	22	DGWE-S-10-G 1/4"-wd
S	400	10	3/8"	47.5	26.5	18.0	27	22	DGWE-S-10-G 3/8"-wd
S	400	12	3/8"	47.5	26.5	18.0	27	24	DGWE-S-12-G 3/8"-wd
S	400	14	1/2"	58.5	33.5	25.0	36	27	DGWE-S-14-G 1/2"-wd
S	400	16	1/2"	58.5	33.5	24.5	36	30	DGWE-S-16-G 1/2"-wd
S	250	20	3/4"	66.0	38.0	26.5	41	36	DGWE-S-20-G 3/4"-wd
S	250	25	1"	72.0	42.5	29.0	46	46	DGWE-S-25-G 1"-wd
S	250	30	1 1/4"					50	DGWE-S-30-G 1 1/4"-wd
S	250	38	1 1/2"					60	DGWE-S-38-G 1 1/2"-wd

Fittings can be supplied with nuts with silver-plated threads to help to prevent galling, or can be supplied body only - no nut or cutting ring.

If you require silver-plated nuts, use suffix -SC. If you require body only, use suffix -OMD.

Eg. DGWE-L-12-G 1/2"-wd-SC, or DGWE-L-12-G 1/2"-wd-OMD.