



Pegasus
hydraulics

Hydraulic hose



17



| | Product Groups | Page |
|---|---|-------|
| | Legend of symbols | 17.02 |
| | Instructions for installation | 17.03 |
| | Calculating the length of hose assemblies | 17.04 |
| | Calculating the length of hose assemblies | 17.05 |
|  | Astro / 2 - DIN EN 854 / 2 TE | 17.06 |
|  | Astro / 3 - DIN EN 854 / 3 TE | 17.07 |
|  | SAE 100 R1A - DIN EN 853 / 1 ST | 17.08 |
|  | Rockmaster / 2 ST - SAE 100 R2A - DIN EN 853 / 2 ST | 17.09 |
|  | Tractor / 1 T - SAE 100 R1AT - DIN EN 853 / 1 SN | 17.10 |
|  | Tractor / 2 T - SAE 100 R2AT - DIN EN 853 / 2 SN | 17.11 |
|  | Tractor / 1 K - DIN EN 857 / 1 SC | 17.12 |
|  | Tractor / 2 K - DIN EN 857 / 2 SC | 17.13 |
|  | Goldenspir / 4 SP - DIN EN 856 / 4 SP | 17.14 |
|  | Goldenspir / 4 SH - DIN EN 856 / 4 SH | 17.15 |
|  | Rockmaster / 13 - DIN EN 856 / R13 | 17.16 |
|  | Rockmaster / 15 - SAE 100 / R15 | 17.17 |
|  | Thermoplastic hose / DIN EN 855 | |
| | R7 | 17.18 |
| | R8 | 17.19 |
|  | Smoothbore PTFE hose / PT1W | 17.20 |
|  | Convuluted PTFE hose / PT3W | 17.21 |

Legend of symbols

BOOK INDEX

SECTION INDEX

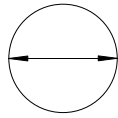

- Inside Diameter (I.D.)

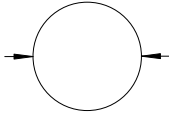

- Outside Diameter (O.D.)

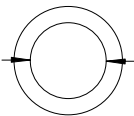

- Reinforcement Outside Diameter



- Burst Pressure:
It is the minimum guaranteed burst pressure of the hose; equivalent or superior to the reference specifications minimum requirements.



- Weight



- Maximum Working Pressure



- Minimum Bend Radius

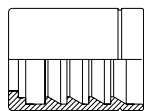

- Ferrule/Socket
- *Continuous Service: Refers to the working temperature range*
- *Max. Operating Temperature (Intermittent Service): Peaks of temperature of short duration and total cumulative duration lower than 5% of the total service life.*
- *Recommended Fluids: Fluid types that the hose can convey with excellent / good chemical compatibility.*

Correct installation increases the service life of hose assemblies!

1. Under pressure, alterations of +2% to -4% can occur in the length of hose assemblies. Hoses should therefore be installed with slack or curves.
2. Hose assemblies should never be installed twisted (no torsion).
3. Hose assemblies should not be bent excessively – use elbow fittings instead!
4. Note minimum bend radius!
5. If vertical displacement occurs, allow for amount of travel.
6. Protect from external damage (use protective spirals).

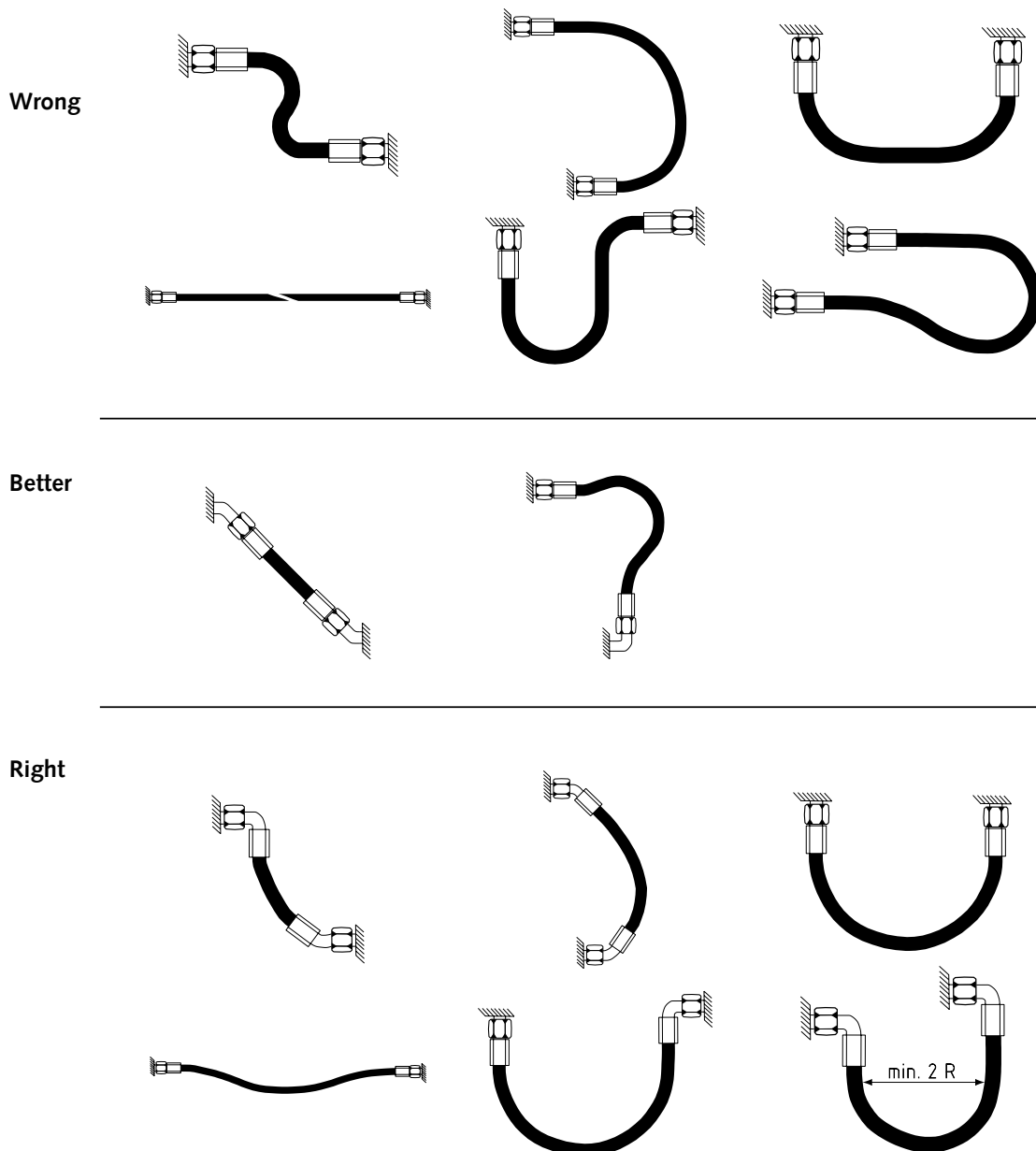

Length Tolerance of Installed Hose Assemblies (acc. to DIN 20066)

| Length mm | Tolerances | | |
|--------------|-------------------|--------------------|--------------------|
| | up to ø 25 | from ø 31 to ø 51 | from ø 60 to ø 100 |
| up to 630 | + 7 mm - 3 mm | + 12 mm - 4 mm | |
| 630 - 1250 | + 12 mm - 4 mm | + 20 mm - 6 mm | + 25 mm - 6 mm |
| 1250 - 2500 | + 20 mm - 6 mm | + 25 mm - 6 mm | |
| 2500 - 8000 | | + 1.5 % - 0.5 % | |
| over 8000 | | + 3 % - 1 % | |

Calculating the Hose Length

The service life of hose assemblies can be increased by proper measurement and installation.

Please follow the following instructions.

Calculation of Fixed Hose Assemblies

$$\text{Overall Length} = L = 2 B + \frac{3 \cdot 14 \cdot R}{D}$$

R = Min. Bend Radius

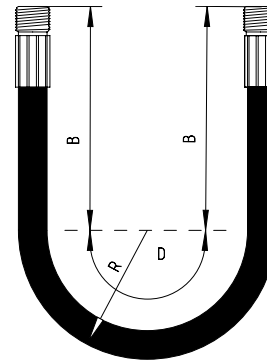

Calculation of Flexible Hose Assemblies

$$\text{Overall Length} = L = 2 B + \frac{3 \cdot 14 \cdot R}{D}$$

Additional length C should be allowed for if vertical movement takes place.

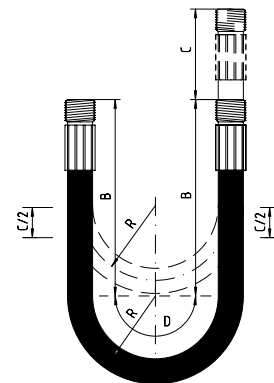

The following table gives the minimum length B that should be left behind the ends of the fittings of a hose assembly.

| DN = ø | 06 | 08 | 10 | 12 | 16 | 19 | 25 | 31 | 38 |
|--------|----|-----|-----|-----|-----|-----|-----|-----|-----|
| B = mm | 90 | 100 | 110 | 120 | 130 | 140 | 160 | 180 | 200 |

Typical Measurements of Hose Assemblies

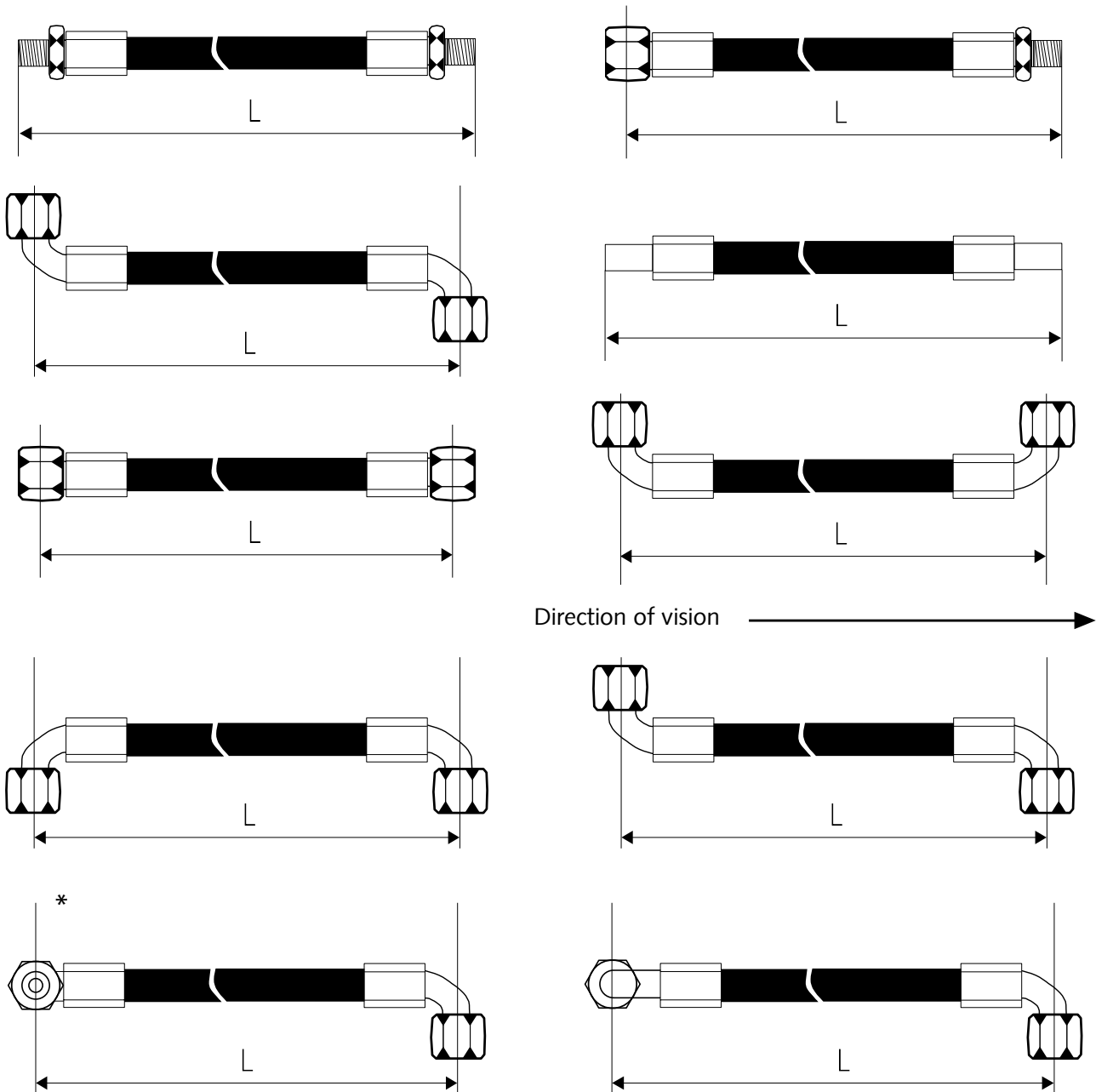

*Sample order: DN 10 R 2 A x 800 DKL 90° / DKL 90° - 90° g. UZ.

The angle of hose assemblies with elbow fittings at either end can be determined as follows:

Look along the hose assembly for which a designation is required, with the rear fitting away from the body pointing upwards.

Now specify how many degrees the front fitting is rotated through in a clockwise (i. UZ) or anti-clockwise (g. UZ) direction.

Tolerance +/- 3°

Swage Ferrule:

P1 - non skive -
Page 2.08



| DN | Hose Size | | I.D. mm | O.D. mm | Max. Working Pressure | | Min. Burst Pressure | | Min. Bend Radius mm | Weight g/m | Part code |
|----|-----------|-------|------------|------------|-----------------------|--------|---------------------|--------|------------------------|---------------|-----------------|
| | dash | in. | | | bar | P.S.I. | bar | P.S.I. | | | |
| 06 | -4 | 1/4" | 6.4 | 13.0 | 75 | 1080 | 300 | 4350 | 40 | 130 | Hose 2 TE-DN 06 |
| 08 | -5 | 5/16" | 7.9 | 14.6 | 68 | 980 | 272 | 3940 | 50 | 145 | Hose 2 TE-DN 08 |
| 10 | -6 | 3/8" | 9.5 | 16.1 | 63 | 910 | 252 | 3650 | 60 | 180 | Hose 2 TE-DN 10 |
| 12 | -8 | 1/2" | 12.7 | 19.2 | 58 | 840 | 232 | 3360 | 70 | 220 | Hose 2 TE-DN 12 |
| 16 | -10 | 5/8" | 15.9 | 23.6 | 50 | 720 | 200 | 2900 | 90 | 290 | Hose 2 TE-DN 16 |
| 19 | -12 | 3/4" | 19.0 | 26.5 | 45 | 650 | 180 | 2610 | 110 | 365 | Hose 2 TE-DN 19 |
| 25 | -16 | 1" | 25.4 | 33.4 | 40 | 580 | 160 | 2320 | 130 | 525 | Hose 2 TE-DN 25 |

Tube: Oil Resistant Synthetic Rubber

Reinforcement: One Textile Braid

Cover: Synthetic Rubber with High Abrasion,
Ozone and Weather Resistance

Continuous Service: -40°C to +100°C

Max. Operating Temperature: 135°C

Recommended Fluids: Mineral Oil, Rape Seed Oil,
Poly Glycol Base Oil, Synthetic Esther Base Oil,
Water / Oil Emulsions, Water

Swage Ferrule:

P2 - non skive -
Page 2.11



| DN | Hose Size | | I.D. mm | O.D. mm | Max. Working Pressure | | Min. Burst Pressure | | Min. Bend Radius mm | Weight g/m | Part code |
|----|-----------|--------|------------|------------|-----------------------|--------|---------------------|--------|------------------------|---------------|-----------------|
| | dash | in. | | | bar | P.S.I. | bar | P.S.I. | | | |
| 06 | -4 | 1/4" | 6.4 | 14.2 | 145 | 2100 | 580 | 8410 | 45 | 150 | Hose 3 TE-DN 06 |
| 08 | -5 | 5/16" | 7.9 | 16.6 | 130 | 1880 | 520 | 7540 | 55 | 210 | Hose 3 TE-DN 08 |
| 10 | -6 | 3/8" | 9.5 | 18.2 | 110 | 1590 | 440 | 6380 | 70 | 230 | Hose 3 TE-DN 10 |
| 12 | -8 | 1/2" | 12.7 | 21.5 | 93 | 1340 | 372 | 5390 | 85 | 290 | Hose 3 TE-DN 12 |
| 16 | -10 | 5/8" | 15.9 | 25.6 | 80 | 1160 | 320 | 4640 | 105 | 385 | Hose 3 TE-DN 16 |
| 19 | -12 | 3/4" | 19.0 | 28.8 | 70 | 1010 | 280 | 4060 | 130 | 450 | Hose 3 TE-DN 19 |
| 25 | -16 | 1" | 25.4 | 35.4 | 55 | 790 | 220 | 3190 | 150 | 570 | Hose 3 TE-DN 25 |
| 31 | -20 | 1 1/4" | 31.8 | 42.5 | 45 | 650 | 180 | 2610 | 190 | 570 | Hose 3 TE-DN 31 |
| 38 | -24 | 1 1/2" | 38.1 | 49.4 | 40 | 580 | 160 | 2320 | 240 | 930 | Hose 3 TE-DN 38 |
| 51 | -32 | 2" | 50.8 | 62.2 | 33 | 470 | 132 | 1910 | 300 | 1300 | Hose 3 TE-DN 51 |
| 60 | -38 | 2 3/8" | 60.0 | 72.0 | 25 | 360 | 100 | 1450 | 400 | 1790 | Hose 3 TE-DN 60 |
| 80 | | 3" | 80.0 | 94.0 | 18 | 260 | 72 | 1040 | 500 | 3050 | Hose 3 TE-DN 80 |

Tube: Oil Resistant Synthetic Rubber

Reinforcement: Two Textile Braids

Cover: Synthetic Rubber with High Abrasion, Ozone and Weather Resistance

DN 60 + DN 80 with Steel Helical Body Wire

Continuous Service: -40°C to +100°C

Max. Operating Temperature: 135°C

Recommended Fluids: Mineral Oil, Rape Seed Oil, Poly Glycol Base Oil, Synthetic Esther Base Oil, Water / Oil Emulsions, Water

Swage Ferrule:

P1 - skive -
Page 2.08



| DN | Hose Size | | I.D. | R.O.D. | O.D. | Max. Working Pressure | | Min. Burst Pressure | | Min. Bend Radius | Weight | Part code |
|----|-----------|--------|------|--------|------|-----------------------|--------|---------------------|--------|------------------|--------|-----------------|
| | dash | in. | | | | bar | P.S.I. | bar | P.S.I. | | | |
| mm | | | mm | mm | mm | | | | | mm | | |
| 06 | -4 | 1/4" | 6.4 | 11.1 | 15.9 | 225 | 3265 | 900 | 13050 | 100 | 310 | Hose 1 ST-DN 06 |
| 08 | -5 | 5/16" | 7.9 | 12.7 | 17.5 | 215 | 3120 | 850 | 12320 | 115 | 340 | Hose 1 ST-DN 08 |
| 10 | -6 | 3/8" | 9.5 | 15.1 | 19.9 | 180 | 2610 | 720 | 10440 | 130 | 430 | Hose 1 ST-DN 10 |
| 12 | -8 | 1/2" | 12.7 | 18.3 | 23.0 | 160 | 2320 | 640 | 9280 | 180 | 530 | Hose 1 ST-DN 12 |
| 16 | -10 | 5/8" | 15.9 | 21.5 | 26.2 | 130 | 1885 | 520 | 7540 | 200 | 625 | Hose 1 ST-DN 16 |
| 19 | -12 | 3/4" | 19.0 | 25.2 | 30.0 | 105 | 1520 | 420 | 6090 | 240 | 780 | Hose 1 ST-DN 19 |
| 25 | -16 | 1" | 25.4 | 33.1 | 37.8 | 88 | 1270 | 350 | 5070 | 300 | 1080 | Hose 1 ST-DN 25 |
| 31 | -20 | 1 1/4" | 31.8 | 40.6 | 45.8 | 63 | 910 | 250 | 3620 | 419 | 1440 | Hose 1 ST-DN 31 |
| 38 | -24 | 1 1/2" | 38.1 | 47.0 | 52.1 | 50 | 725 | 200 | 2900 | 500 | 1670 | Hose 1 ST-DN 38 |
| 51 | -32 | 2" | 50.8 | 60.4 | 66.4 | 40 | 580 | 160 | 2320 | 630 | 2450 | Hose 1 ST-DN 51 |

Tube: Oil Resistant Synthetic Rubber

Reinforcement: One High Tensile Steel Braid

Cover: Synthetic Rubber with High Abrasion, Ozone, Weather and Flame Resistance

Continuous Service: -40°C to +100°C

Max. Operating Temperature: 125°C

Recommended Fluids: Mineral Oil, Rape Seed Oil, Poly Glycol Base Oil, Synthetic Esther Base Oil, Water / Oil Emulsions, Water

Swage Ferrule:

P3 - skive -
Page 2.10



| DN | Hose Size | | I.D. | R.O.D. | O.D. | Max. Working Pressure | | Min. Burst Pressure | | Min. Bend Radius | Weight | Part code |
|----|-----------|--------|------|--------|------|-----------------------|--------|---------------------|--------|------------------|--------|-----------------|
| | dash | in. | | | | bar | P.S.I. | bar | P.S.I. | | | |
| 06 | -4 | 1/4" | 6.4 | 12.7 | 17.2 | 400 | 5800 | 1750 | 25370 | 100 | 460 | Hose 2 ST-DN 06 |
| 08 | -5 | 5/16" | 7.9 | 14.3 | 18.9 | 350 | 5070 | 1480 | 21460 | 114 | 510 | Hose 2 ST-DN 08 |
| 10 | -6 | 3/8" | 9.5 | 16.7 | 21.3 | 350 | 5070 | 1400 | 20300 | 127 | 635 | Hose 2 ST-DN 10 |
| 12 | -8 | 1/2" | 12.7 | 19.8 | 24.5 | 350 | 5070 | 1400 | 20300 | 178 | 770 | Hose 2 ST-DN 12 |
| 16 | -10 | 5/8" | 15.9 | 23.0 | 27.7 | 250 | 3620 | 1020 | 14790 | 200 | 890 | Hose 2 ST-DN 16 |
| 19 | -12 | 3/4" | 19.0 | 27.0 | 31.6 | 215 | 3120 | 900 | 13050 | 240 | 1090 | Hose 2 ST-DN 19 |
| 25 | -16 | 1" | 25.4 | 34.8 | 39.5 | 175 | 2530 | 670 | 9710 | 300 | 1530 | Hose 2 ST-DN 25 |
| 31 | -20 | 1 1/4" | 31.8 | 44.3 | 50.6 | 140 | 2030 | 600 | 8700 | 419 | 2335 | Hose 2 ST-DN 31 |
| 38 | -24 | 1 1/2" | 38.1 | 50.7 | 57.0 | 100 | 1450 | 500 | 7250 | 500 | 2680 | Hose 2 ST-DN 38 |
| 51 | -32 | 2" | 50.8 | 63.5 | 69.8 | 90 | 1360 | 420 | 6090 | 630 | 3625 | Hose 2 ST-DN 51 |

Tube: Oil Resistant Synthetic Rubber

Reinforcement: Two High Tensile Steel Braids

Cover: Synthetic Rubber with High Abrasion, Ozone, Weather and Flame Resistance

Continuous Service: -40°C to +100°C

Max. Operating Temperature: 125°C

Recommended Fluids: Mineral Oil, Rape Seed Oil, Poly Glycol Base Oil, Synthetic Esther Base Oil, Water / Oil Emulsions, Water

Swage Ferrule:

P1 - skive and non skive -
Page 2.08

P5 - non skive -
Page 2.13



| DN | Hose Size | | I.D. | R.O.D. | O.D. | Max. Working Pressure | | Min. Burst Pressure | | Min. Bend Radius | Weight g/m | Part code |
|----|-----------|--------|------|--------|------|-----------------------|--------|---------------------|--------|------------------|------------|-----------------|
| | dash | in. | | | | bar | P.S.I. | bar | P.S.I. | | | |
| mm | | | mm | mm | mm | bar | P.S.I. | bar | P.S.I. | mm | | |
| 05 | -3 | 3/16" | 4.8 | 9.5 | 11.5 | 250 | 3620 | 1000 | 14500 | 89 | 195 | Hose 1 SN-DN 05 |
| 06 | -4 | 1/4" | 6.4 | 11.2 | 13.2 | 225 | 3260 | 900 | 13050 | 100 | 240 | Hose 1 SN-DN 06 |
| 08 | -5 | 5/16" | 7.9 | 12.8 | 14.8 | 215 | 3110 | 850 | 12320 | 114 | 280 | Hose 1 SN-DN 08 |
| 10 | -6 | 3/8" | 9.5 | 15.1 | 17.1 | 180 | 2610 | 720 | 10440 | 127 | 360 | Hose 1 SN-DN 10 |
| 12 | -8 | 1/2" | 12.7 | 18.1 | 20.1 | 160 | 2320 | 640 | 9280 | 178 | 450 | Hose 1 SN-DN 12 |
| 16 | -10 | 5/8" | 15.9 | 21.3 | 23.3 | 130 | 1880 | 520 | 7540 | 200 | 510 | Hose 1 SN-DN 16 |
| 19 | -12 | 3/4" | 19.0 | 25.3 | 27.3 | 105 | 1520 | 420 | 6090 | 240 | 650 | Hose 1 SN-DN 19 |
| 25 | -16 | 1" | 25.4 | 33.1 | 35.7 | 88 | 1270 | 350 | 5070 | 300 | 960 | Hose 1 SN-DN 25 |
| 31 | -20 | 1 1/4" | 31.8 | 40.6 | 43.3 | 63 | 910 | 250 | 3620 | 419 | 1250 | Hose 1 SN-DN 31 |
| 38 | -24 | 1 1/2" | 38.1 | 47.0 | 49.7 | 50 | 720 | 200 | 2900 | 500 | 1600 | Hose 1 SN-DN 38 |
| 51 | -32 | 2" | 50.8 | 60.4 | 63.1 | 40 | 580 | 160 | 2320 | 630 | 2200 | Hose 1 SN-DN 51 |

Tube: Oil Resistant Synthetic Rubber

Reinforcement: One High Tensile Steel Braid

Cover: Synthetic Rubber with High Temperature, Ozone and Abrasion Resistance

Continuous Service: -40°C to +100°C

Max. Operating Temperature: 125°C

Recommended Fluids: Mineral Oil, Rape Seed Oil, Poly Glycol Base Oil, Synthetic Esther Base Oil, Water / Oil Emulsions, Water

Swage Ferrule:

P3 - skive - DN 06 up to DN 51 -
Page 2.10

P2 - non skive - DN 06 up to DN 25 -
Page 2.11

P8 - non skive - DN 31 up to DN 76 -
Page 2.12

P5 - non skive -
Page 2.13



| DN | Hose Size | | I.D. | R.O.D. | O.D. | Max. Working Pressure | | Min. Burst Pressure | | Min. Bend Radius | Weight | Part code |
|----|-----------|--------|------|--------|------|-----------------------|--------|---------------------|--------|------------------|--------|-----------------|
| | dash | in. | | | | bar | P.S.I. | bar | P.S.I. | | | |
| 05 | -3 | 3/16" | 4.8 | 11.3 | 13.3 | 415 | 6010 | 1650 | 23920 | 89 | 315 | Hose 2 SN-DN 05 |
| 06 | -4 | 1/4" | 6.4 | 12.7 | 14.7 | 400 | 5800 | 1600 | 23200 | 100 | 360 | Hose 2 SN-DN 06 |
| 08 | -5 | 5/16" | 7.9 | 14.3 | 16.3 | 350 | 5070 | 1400 | 20300 | 114 | 400 | Hose 2 SN-DN 08 |
| 10 | -6 | 3/8" | 9.5 | 16.7 | 18.7 | 330 | 4780 | 1320 | 19140 | 127 | 510 | Hose 2 SN-DN 10 |
| 12 | -8 | 1/2" | 12.7 | 19.8 | 21.8 | 275 | 3980 | 1100 | 15950 | 178 | 620 | Hose 2 SN-DN 12 |
| 16 | -10 | 5/8" | 15.9 | 23.0 | 25.0 | 250 | 3620 | 1000 | 14500 | 200 | 715 | Hose 2 SN-DN 16 |
| 19 | -12 | 3/4" | 19.0 | 27.0 | 29.0 | 215 | 3110 | 850 | 12320 | 240 | 920 | Hose 2 SN-DN 19 |
| 25 | -16 | 1" | 25.4 | 34.8 | 36.8 | 165 | 2390 | 650 | 9420 | 300 | 1305 | Hose 2 SN-DN 25 |
| 31 | -20 | 1 1/4" | 31.8 | 44.3 | 47.0 | 125 | 1810 | 500 | 7250 | 419 | 1965 | Hose 2 SN-DN 31 |
| 38 | -24 | 1 1/2" | 38.1 | 50.7 | 53.4 | 90 | 1300 | 360 | 5220 | 500 | 2265 | Hose 2 SN-DN 38 |
| 51 | -32 | 2" | 50.8 | 63.5 | 66.2 | 80 | 1160 | 320 | 4640 | 630 | 3115 | Hose 2 SN-DN 51 |
| 60 | -38 | 2 3/8" | 60.0 | 68.8 | 71.5 | 90 | 1300 | 360 | 5220 | 650 | 2660 | Hose 2 SN-DN 60 |
| 76 | -48 | 3" | 76.2 | 87.8 | 90.5 | 45 | 650 | 180 | 2610 | 900 | 3180 | Hose 2 SN-DN 76 |

Tube: Oil Resistant Synthetic Rubber

Reinforcement: Two High Tensile Steel Braids

Cover: Synthetic Rubber with High Temperature, Ozone and Abrasion Resistance

Continuous Service: -40°C to +100°C

Max. Operating Temperature: 125°C

Recommended Fluids: Mineral Oil, Rape Seed Oil, Poly Glycol Base Oil, Synthetic Esther Base Oil, Water / Oil Emulsions, Water

Swage Ferrule:

P9 - non skive - DN 06 up to DN 12 -
Page 2.09

P1 - non skive - DN 16 - 19 - 25 -
Page 2.08



| DN | Hose Size | | I.D. | R.O.D. | O.D. | Max. Working Pressure | | Min. Burst Pressure | | Min. Bend Radius | Weight | Part code |
|----|-----------|-------|------|--------|------|-----------------------|--------|---------------------|--------|------------------|--------|-----------------|
| | dash | in. | | | | bar | P.S.I. | bar | P.S.I. | | | |
| 06 | -4 | 1/4" | 6.4 | 10.2 | 12.0 | 225 | 3260 | 1050 | 15220 | 50 | 180 | Hose 1 SC-DN 06 |
| 08 | -5 | 5/16" | 7.9 | 11.5 | 13.6 | 215 | 3110 | 1000 | 14500 | 55 | 210 | Hose 1 SC-DN 08 |
| 10 | -6 | 3/8" | 9.5 | 13.6 | 15.5 | 180 | 2610 | 850 | 12320 | 60 | 260 | Hose 1 SC-DN 10 |
| 12 | -8 | 1/2" | 12.7 | 17.1 | 18.9 | 160 | 2320 | 660 | 9570 | 70 | 335 | Hose 1 SC-DN 12 |
| 16 | -10 | 5/8" | 15.9 | 20.6 | 22.4 | 130 | 1880 | 620 | 8990 | 90 | 440 | Hose 1 SC-DN 16 |
| 19 | -12 | 3/4" | 19.0 | 23.9 | 25.9 | 105 | 1520 | 480 | 6960 | 100 | 535 | Hose 1 SC-DN 19 |
| 25 | -16 | 1" | 25.4 | 31.3 | 33.3 | 88 | 1270 | 380 | 5510 | 160 | 765 | Hose 1 SC-DN 25 |

High Flexibility, excellent Bend Radius, low Weight

Tube: Oil Resistant Synthetic Rubber

Reinforcement: One High Tensile Steel Braid

Cover: Synthetic Rubber with High Abrasion, Ozone, Weather and Flame Resistance

Continuous Service: -40°C to +100°C

Max. Operating Temperature: 125°C

Recommended Fluids: Mineral Oil, Rape Seed Oil, Poly Glycol Base Oil, Synthetic Esther Base Oil, Water / Oil Emulsions, Water

Swage Ferrule:

P1 - skive and non skive -
Page 2.08

P5 - non skive -
Page 2.13

P8 - non skive -
Page 2.12



| DN | Hose Size | | I.D. | R.O.D. | O.D. | Max. Working Pressure | | Min. Burst Pressure | | Min. Bend Radius | Weight | Part code |
|----|-----------|--------|------|--------|------|-----------------------|--------|---------------------|--------|------------------|--------|-----------------|
| | dash | in. | | | | bar | P.S.I. | bar | P.S.I. | | | |
| mm | | | mm | mm | mm | | | | | mm | | |
| 06 | -4 | 1/4" | 6.4 | 11.3 | 13.1 | 400 | 5800 | 1850 | 26820 | 45 | 270 | Hose 2 SC-DN 06 |
| 08 | -5 | 5/16" | 7.9 | 12.9 | 14.7 | 350 | 5070 | 1700 | 24650 | 55 | 325 | Hose 2 SC-DN 08 |
| 10 | -6 | 3/8" | 9.5 | 15.0 | 16.8 | 330 | 4780 | 1500 | 21750 | 65 | 395 | Hose 2 SC-DN 10 |
| 12 | -8 | 1/2" | 12.7 | 18.5 | 20.3 | 275 | 3980 | 1220 | 17690 | 80 | 495 | Hose 2 SC-DN 12 |
| 16 | -10 | 5/8" | 15.9 | 21.8 | 23.6 | 250 | 3620 | 1050 | 15220 | 90 | 595 | Hose 2 SC-DN 16 |
| 19 | -12 | 3/4" | 19.0 | 25.6 | 27.6 | 215 | 3110 | 920 | 13340 | 120 | 800 | Hose 2 SC-DN 19 |
| 25 | -16 | 1" | 25.4 | 33.0 | 35.2 | 165 | 2390 | 720 | 10440 | 160 | 1135 | Hose 2 SC-DN 25 |
| 31 | -20 | 1 1/4" | 31.8 | 41.1 | 43.6 | 125 | 1810 | 560 | 8120 | 250 | 1610 | Hose 2 SC-DN 31 |
| 38 | -24 | 1 1/2" | 38.1 | 47.7 | 50.7 | 100 | 1450 | 400 | 5800 | 300 | 1935 | Hose 2 SC-DN 38 |
| 51 | -32 | 2" | 50.8 | 60.4 | 63.4 | 90 | 1300 | 360 | 5220 | 400 | 2490 | Hose 2 SC-DN 51 |
| 63 | -40 | 2 1/2" | 63.5 | 73.0 | 76.0 | 70 | 1010 | 300 | 4350 | 760 | 2980 | Hose 2 SC-DN 63 |
| 76 | -48 | 3" | 76.2 | 87.8 | 90.5 | 45 | 650 | 180 | 2610 | 900 | 3250 | Hose 2 SC-DN 76 |

High Flexibility, excellent Bend Radius, low Weight

Tube: Oil Resistant Synthetic Rubber

Reinforcement: Two High Tensile Steel Braids

Cover: Synthetic Rubber with High Abrasion, Ozone, Weather and Flame Resistance

Continuous Service: -40°C to +100°C

Max. Operating Temperature: 125°C

Recommended Fluids: Mineral Oil, Rape Seed Oil, Poly Glycol Base Oil, Synthetic Esther Base Oil, Water / Oil Emulsions, Water

Swage Ferrule:

P3 - skive -
Page 2.10



| DN | Hose Size | | I.D. | R.O.D. | O.D. | Max. Working Pressure | | Min. Burst Pressure | | Min. Bend Radius | Weight | Part code |
|----|-----------|--------|------|--------|------|-----------------------|--------|---------------------|--------|------------------|--------|-----------------|
| | dash | in. | | | | bar | P.S.I. | bar | P.S.I. | | | |
| 06 | -4 | 1/4" | 6.4 | 14.7 | 17.6 | 485 | 7250 | 2400 | 34800 | 100 | 605 | Hose 4 SP-DN 06 |
| 10 | -6 | 3/8" | 9.5 | 17.6 | 21.1 | 450 | 6670 | 2100 | 30450 | 110 | 770 | Hose 4 SP-DN 10 |
| 12 | -8 | 1/2" | 12.7 | 20.3 | 24.3 | 420 | 6160 | 1900 | 27550 | 120 | 925 | Hose 4 SP-DN 12 |
| 16 | -10 | 5/8" | 15.9 | 23.7 | 27.9 | 380 | 5800 | 1600 | 23200 | 140 | 1145 | Hose 4 SP-DN 16 |
| 19 | -12 | 3/4" | 19.0 | 28.2 | 31.9 | 380 | 5510 | 1600 | 23200 | 170 | 1510 | Hose 4 SP-DN 19 |
| 25 | -16 | 1" | 25.4 | 35.0 | 39.0 | 320 | 4640 | 1400 | 20300 | 340 | 1970 | Hose 4 SP-DN 25 |
| 31 | -20 | 1 1/4" | 31.8 | 46.1 | 49.9 | 210 | 3040 | 1250 | 18120 | 460 | 3060 | Hose 4 SP-DN 31 |
| 38 | -24 | 1 1/2" | 38.1 | 52.4 | 57.0 | 185 | 2680 | 1000 | 14500 | 560 | 3680 | Hose 4 SP-DN 38 |
| 51 | -32 | 2" | 50.8 | 65.4 | 70.8 | 175 | 2530 | 1000 | 14500 | 660 | 5325 | Hose 4 SP-DN 51 |

Tube: Oil Resistant Synthetic Rubber

Reinforcement: Four High Tensile Steel Spirals

Cover: Synthetic Rubber with High Temperature, Ozone, Abrasion, Weather and Flame Resistance

Continuous Service: -40°C to +100°C

Max. Operating Temperature: 125°C

Recommended Fluids: Mineral Oil, Water, Glycols, Mineral Oil / Water Emulsions

Swage Ferrule:

Interlock P4-I - internal and external skive - Page 3.02



| DN | Hose Size | | I.D. | R.O.D. | O.D. | Max. Working Pressure | | Min. Burst Pressure | | Min. Bend Radius | Weight g/m | Part code |
|----|-----------|--------|------|--------|------|-----------------------|--------|---------------------|--------|------------------|---------------|-----------------|
| | dash | in. | | | | bar | P.S.I. | bar | P.S.I. | | | |
| 19 | -12 | 3/4" | 19.0 | 28.2 | 31.9 | 420 | 6090 | 1750 | 25370 | 210 | 1540 | Hose 4 SH-DN 19 |
| 25 | -16 | 1" | 25.4 | 35.1 | 38.1 | 385 | 5580 | 1750 | 25370 | 220 | 2085 | Hose 4 SH-DN 25 |
| 31 | -20 | 1 1/4" | 31.8 | 42.2 | 45.0 | 350 | 5070 | 1400 | 20300 | 420 | 2460 | Hose 4 SH-DN 31 |
| 38 | -24 | 1 1/2" | 38.1 | 49.1 | 52.4 | 300 | 4350 | 1250 | 18120 | 560 | 3190 | Hose 4 SH-DN 38 |
| 51 | -32 | 2" | 50.8 | 63.5 | 67.5 | 250 | 3620 | 1000 | 14500 | 700 | 4500 | Hose 4 SH-DN 51 |

Tube: Oil Resistant Synthetic Rubber

Reinforcement: Four High Tensile Steel Spirals

Cover: Synthetic Rubber with High Temperature, Ozone, Abrasion, Weather and Flame Resistance

Continuous Service: -40°C to +100°C

Max. Operating Temperature: 125°C

Recommended Fluids: Mineral Oil, Water, Glycols, Mineral Oil / Water Emulsions

Swage Ferrule:

Interlock P6-I - internal and external skive - Page 3.03



| DN | Hose Size | | I.D. | R.O.D. | O.D. | Max. Working Pressure | | Min. Burst Pressure | | Min. Bend Radius | Weight | Part code |
|----|-----------|--------|------|--------|------|-----------------------|--------|---------------------|--------|------------------|--------|----------------|
| | dash | in. | | | | bar | P.S.I. | bar | P.S.I. | | | |
| 19 | -12 | 3/4" | 19.0 | 29.0 | 31.8 | 350 | 5070 | 1950 | 28270 | 240 | 1620 | Hose R13-DN 19 |
| 25 | -16 | 1" | 25.4 | 36.0 | 39.2 | 350 | 5070 | 1650 | 23920 | 300 | 2195 | Hose R13-DN 25 |
| 31 | -20 | 1 1/4" | 31.8 | 47.0 | 50.0 | 350 | 5070 | 1600 | 23200 | 419 | 3610 | Hose R13-DN 31 |
| 38 | -24 | 1 1/2" | 38.1 | 54.6 | 57.5 | 350 | 5070 | 1600 | 23200 | 500 | 4720 | Hose R13-DN 38 |
| 51 | -32 | 2" | 50.8 | 68.4 | 72.0 | 350 | 5070 | 1500 | 21750 | 630 | 6285 | Hose R13-DN 51 |

Tube: Oil Resistant Synthetic Rubber

Reinforcement: Four High Tensile Steel Spirals (DN <31) - Six High Tensile Steel Spirals (DN 31 - 38 - 51)

Cover: Synthetic Rubber with High Temperature, Ozone, Abrasion, Weather and Flame Resistance

Continuous Service: -40°C to +121°C

Max. Operating Temperature: 125°C

Recommended Fluids: Mineral Oil, Water, Glycols, Mineral Oil / Water Emulsions

Swage Ferrule:

Interlock P7-I - internal and external skive - Page 3.04



| DN | Hose Size | | I.D. | R.O.D. | O.D. | Max. Working Pressure | | Min. Burst Pressure | | Min. Bend Radius | Weight g/m | Part code |
|----|-----------|--------|------|--------|------|-----------------------|--------|---------------------|--------|------------------|---------------|----------------|
| | dash | in. | | | | bar | P.S.I. | bar | P.S.I. | | | |
| mm | | | mm | mm | mm | bar | P.S.I. | bar | P.S.I. | mm | | |
| 19 | -12 | 3/4" | 19.0 | 28.2 | 31.0 | 420 | 6090 | 1750 | 25370 | 265 | 1430 | Hose R15-DN 19 |
| 25 | -16 | 1" | 25.4 | 35.1 | 38.1 | 420 | 6090 | 1750 | 25370 | 267 | 2040 | Hose R15-DN 25 |
| 31 | -20 | 1 1/4" | 31.8 | 46.3 | 49.5 | 420 | 6090 | 1680 | 24360 | 267 | 3670 | Hose R15-DN 31 |
| 38 | -24 | 1 1/2" | 38.1 | 54.6 | 57.5 | 420 | 6090 | 1680 | 24360 | 315 | 4720 | Hose R15-DN 38 |

Tube: Oil Resistant Synthetic Rubber

Reinforcement: Four High Tensile Steel Spirals (DN <31) - Six High Tensile Steel Spirals (DN 31 - 38)

Cover: Synthetic Rubber with High Temperature, Ozone, Abrasion, Weather and Flame Resistance

Continuous Service: -40°C to +121°C

Max. Operating Temperature: 125°C

Recommended Fluids: Mineral Oil, Water, Glycols, Mineral Oil / Water Emulsions

Swage Ferrule:

PF-R7 - Page 2.07



| DN | Hose Size | | I.D. +/-0.5 mm | O.D. +/-0.5 mm | Max. Working Pressure | | Min. Burst Pressure | | Min. Bend Radius mm | Weight g/m | Part code |
|----|-----------|-------|----------------------|----------------------|-----------------------|--------|---------------------|--------|------------------------|---------------|---------------|
| | dash | in. | | | bar | P.S.I. | bar | P.S.I. | | | |
| 05 | | 3/16" | 4.8 | 10.2 | 210 | 3040 | 840 | 12180 | 35 | 80 | Hose R7-DN 05 |
| 06 | | 1/4" | 6.4 | 12.0 | 190 | 2750 | 760 | 11020 | 50 | 95 | Hose R7-DN 06 |
| 08 | | 5/16" | 7.9 | 14.3 | 187 | 2710 | 750 | 10870 | 55 | 135 | Hose R7-DN 08 |
| 10 | | 3/8" | 9.5 | 16.3 | 175 | 2530 | 700 | 10150 | 75 | 165 | Hose R7-DN 10 |
| 12 | | 1/2" | 12.7 | 20.3 | 140 | 2030 | 560 | 8120 | 95 | 225 | Hose R7-DN 12 |
| 16 | | 5/8" | 16.0 | 23.5 | 100 | 1450 | 400 | 5800 | 203 | 230 | Hose R7-DN 16 |
| 19 | | 3/4" | 19.0 | 27.5 | 85 | 1230 | 340 | 4930 | 254 | 260 | Hose R7-DN 19 |
| 25 | | 1" | 25.0 | 33.3 | 70 | 1010 | 280 | 4060 | 305 | 360 | Hose R7-DN 25 |

Tube: Oil Resistant Thermoplastic Elastomer

Reinforcement: Two Polyester Braids

Cover: Thermoplastic Elastomer with High Ozone and Abrasion Resistance

Continuous Service: -40°C to +100°C

Max. Operating Temperature: +100°C for Oil, +65°C for Air, Water and Water Based Fluids

Swage Ferrule:

PF-R7 - Page 2.07



| DN | Hose Size | | I.D. +/-0.5 mm | O.D. +/-0.5 mm | Max. Working Pressure | | Min. Burst Pressure | | Min. Bend Radius mm | Weight g/m | Part code |
|----|-----------|-------|----------------------|----------------------|-----------------------|--------|---------------------|--------|------------------------|---------------|---------------|
| | dash | in. | | | bar | P.S.I. | bar | P.S.I. | | | |
| 05 | | 3/16" | 4.8 | 10.0 | 350 | 5075 | 1400 | 20300 | 35 | 72 | Hose R8-DN 05 |
| 06 | | 1/4" | 6.4 | 11.8 | 350 | 5075 | 1400 | 20300 | 50 | 86 | Hose R8-DN 06 |
| 08 | | 5/16" | 8.0 | 14.3 | 325 | 4710 | 1300 | 18850 | 60 | 126 | Hose R8-DN 08 |
| 10 | | 3/8" | 9.7 | 16.0 | 280 | 4060 | 1120 | 16240 | 80 | 149 | Hose R8-DN 10 |
| 12 | | 1/2" | 13.0 | 20.3 | 245 | 3550 | 980 | 14210 | 95 | 225 | Hose R8-DN 12 |

Tube: Oil Resistant Thermoplastic Elastomer

Reinforcement: Two Polyester Braids

Cover: Thermoplastic Elastomer with High Ozone and Abrasion Resistance

Continuous Service: -40°C to +100°C

Max. Operating Temperature: +100°C for Oil, +65°C for Air, Water and Water Based Fluids

Swage Ferrule:

PF-PTFE - Page 2.05

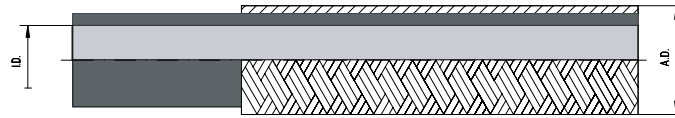

| DN | Hose Size | | I.D. +/- 0.5 | O.D. +/- 0.5 | Max. Working Pressure | | Min. Bend Radius | Weight | Part code |
|----|-----------|-------|-----------------|-----------------|-----------------------|--------|------------------|--------|-----------------|
| | dash | in. | | | bar | P.S.I. | | | |
| mm | | | mm | mm | | | mm | g/m | |
| 05 | | 3/16" | 5.0 | 8.2 | 240 | 3480 | 45 | 83 | Hose PT1W-DN 05 |
| 06 | | 1/4" | 6.7 | 10.0 | 240 | 3480 | 100 | 126 | Hose PT1W-DN 06 |
| 08 | | 5/16" | 8.2 | 11.7 | 200 | 2900 | 120 | 172 | Hose PT1W-DN 08 |
| 10 | | 3/8" | 10.3 | 13.8 | 175 | 2530 | 140 | 223 | Hose PT1W-DN 10 |
| 12 | | 1/2" | 13.0 | 17.0 | 150 | 2170 | 160 | 293 | Hose PT1W-DN 12 |
| 16 | | 5/8" | 16.0 | 20.2 | 135 | 1950 | 190 | 360 | Hose PT1W-DN 16 |
| 19 | | 3/4" | 19.0 | 23.2 | 110 | 1590 | 230 | 423 | Hose PT1W-DN 19 |
| 25 | | 1" | 25.4 | 30.3 | 80 | 1160 | 300 | 640 | Hose PT1W-DN 25 |

With flat, thick PTFE-Tube (Heavy Wall)

Reinforcement: One Braid of Stainless Wire - AISI 304

Max. Operating Temperature: -60° to +260°C

The working pressure apply to working temperatures from +20°C to +50°C.

Swage Ferrule:

PF-W-PTFE - Page 2.06

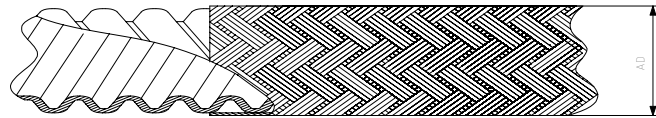

| DN | Hose Size | | I.D. +/-0.5 | O.D. | Tol. | Max. Working Pressure | | Min. Bend Radius | Weight g/m | Part code |
|----|-----------|--------|----------------|------|-------|-----------------------|--------|------------------|---------------|-----------------|
| | dash | in. | | | | bar | P.S.I. | | | |
| mm | | | mm | mm | mm | | | mm | | |
| 06 | | 1/4" | | 11.6 | ± 0.5 | 130 | 1880 | 18 | | Hose PT3W-DN 06 |
| 08 | | 5/16" | | 12.7 | ± 0.5 | 120 | 1740 | 19 | | Hose PT3W-DN 08 |
| 10 | | 3/8" | | 15.6 | ± 0.6 | 110 | 1590 | 20 | | Hose PT3W-DN 10 |
| 12 | | 1/2" | | 18.9 | ± 0.8 | 100 | 1450 | 25 | | Hose PT3W-DN 12 |
| 16 | | 5/8" | | 22.2 | ± 0.8 | 70 | 1010 | 50 | | Hose PT3W-DN 16 |
| 19 | | 3/4" | | 26.4 | ± 1.1 | 60 | 870 | 65 | | Hose PT3W-DN 19 |
| 25 | | 1" | | 33.0 | ± 1.3 | 40 | 580 | 90 | | Hose PT3W-DN 25 |
| 31 | | 1 1/4" | | 40.5 | ± 1.5 | 30 | 430 | 127 | | Hose PT3W-DN 31 |

PTFE-Convolut-ed-Hose with 1 braid

Max. Operating Temperature: -60° to +260°C

The working pressure apply to working temperatures from +20°C to +50°C.