

VORMONTAGESTUTZEN UND SCHMIERSTOFFE PRE-INSTALLATION DIES AND LUBRICANTS

| | | |
|-------------------|-----------------------|------|
| VORMONTAGESTUTZEN | PRE-INSTALLATION DIES | 12.3 |
| SCHMIERSTOFFE | LUBRICANTS | 12.4 |

VORMONTAGESTUTZEN

PRE-INSTALLATION DIES

Stahl - gehärtet
Für Montage von Hand

Steel - hardened
For assembly by hand

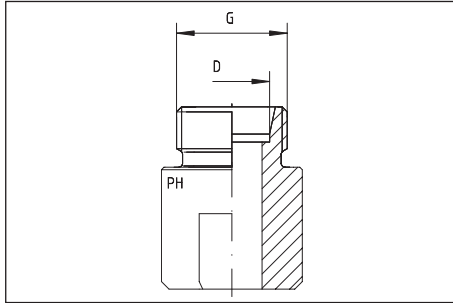

| Reihe Series | Rohr A.D. Tube O.D. D | Gewinde Thread G | Bestellzeichen Order-Code |
|-----------------|-----------------------------|------------------------|------------------------------|
| LL | 4 | M 8 x 1 | VOST-LL-04 |
| LL | 6 | M 10 x 1 | VOST-LL-06 |
| LL | 8 | M 12 x 1 | VOST-LL-08 |
| | | | |
| L | 6 | M 12 x 1,5 | VOST-L-06 |
| L | 8 | M 14 x 1,5 | VOST-L-08 |
| L | 10 | M 16 x 1,5 | VOST-L-10 |
| L | 12 | M 18 x 1,5 | VOST-L-12 |
| L | 15 | M 22 x 1,5 | VOST-L-15 |
| L | 18 | M 26 x 1,5 | VOST-L-18 |
| L | 22 | M 30 x 2 | VOST-L-22 |
| L | 28 | M 36 x 2 | VOST-L-28 |
| L | 35 | M 45 x 2 | VOST-L-35 |
| L | 42 | M 52 x 2 | VOST-L-42 |
| | | | |
| S | 6 | M 14 x 1,5 | VOST-S-06 |
| S | 8 | M 16 x 1,5 | VOST-S-08 |
| S | 10 | M 18 x 1,5 | VOST-S-10 |
| S | 12 | M 20 x 1,5 | VOST-S-12 |
| S | 14 | M 22 x 1,5 | VOST-S-14 |
| S | 16 | M 24 x 1,5 | VOST-S-16 |
| S | 20 | M 30 x 2 | VOST-S-20 |
| S | 25 | M 36 x 2 | VOST-S-25 |
| S | 30 | M 42 x 2 | VOST-S-30 |
| S | 38 | M 52 x 2 | VOST-S-38 |

SCHMIERSTOFFE

LUBRICANTS

Für die Montage von Schraubverbindungen
aus Edelstahl

For assembly of stainless steel couplings

Öl-Jokisch HDS 400 á 250 ml
-20°C bis +120°C

Bestellzeichen
Order-Code
Öl-HDS 250 ml

Oil-Jokisch HDS 400 á 250 ml
-20°C to +120°C

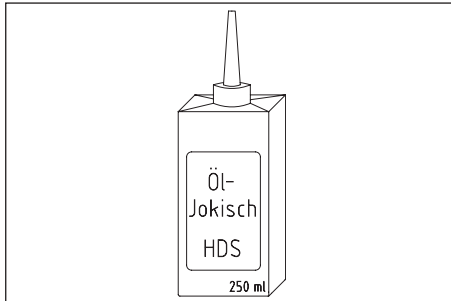

Weißer Paste - Gleitmo 810 á 50 g
-25°C bis +80°C

Bestellzeichen
Order-Code
Gleitmo 810

White grease paste - Gleitmo 810 á 50 g
-25°C to +80°C



High-Tech Paste ASW 040 P á 120 g - metallfrei
-40°C bis +1400°C

Bestellzeichen
Order-Code
ASW 040P-120 g

High-Tech grease paste ASW 040 P á 120 g - metal free
-40°C to +1400°C

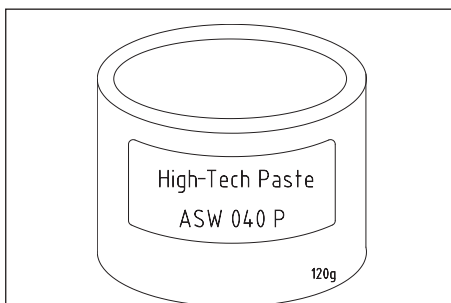

Weißer Fettpaste - Gleitmo 815
-45°C / +110°C; kurzzeitig bis 180°C
Sprühdose á 400 ml

Bestellzeichen
Order-Code
Gleitmo 815

White grease paste - Gleitmo 815
-45°C / +110°C; short term +180°C
Aerosol á 400 ml

